

## Data sheet

Commercial Art.No.: 0D.S04.3427.5

jumper bar IVB WTN 4-4

jumper bar IVB WTN 4-4 modular spacing 6.1 mm, insulated yes, number of poles 4, color red, mounting method pluggable, inflammability class of insulation material acc. with ul94 V0

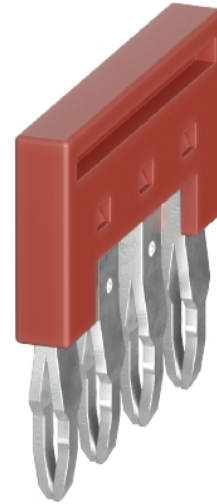

|                    |               |
|--------------------|---------------|
| Commercial Art.No. | 0D.S04.3427.5 |
| EAN                | 4049088723117 |
| Order Unit         | 200           |

## Technical data

### general

|  |                 |
|--|-----------------|
| color  | red             |
| inflammability class of insulation material acc. with UL94 | V0              |
| modular spacing  | 6.1 mm          |
| number of bridged clamps                                   | 4               |
| mounting method  | pluggable       |
| insulated  | yes             |
| model  | cross connector |

### classification

|          |          |
|----------|----------|
| ETIM 9.0 | EC000489 |
|----------|----------|

### product compliance

|                              |           |
|------------------------------|-----------|
| REACH-SVHC conformity status | compliant |
|------------------------------|-----------|

A  
 © Alle Rechte vorbehalten  
 © All rights reserved  
 Vertraulichkeitsklasse  
 Confidentiality Class: Vertraulich  
 Confidential

B  
 These dimensions will be especially checked at delivery  
 Only inspection dimensions  
 With /E marked dimensions are only valid for internal use

C  
 Diese Maße werden bei Abnahme besonders geprüft  
 Ausschließlich Prüfmaße  
 Mit /E gekennzeichnete Maße sind nur für interne Zwecke gültig

D  
 E  
 F

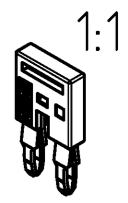
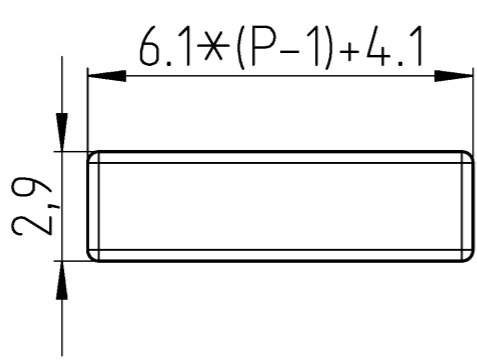
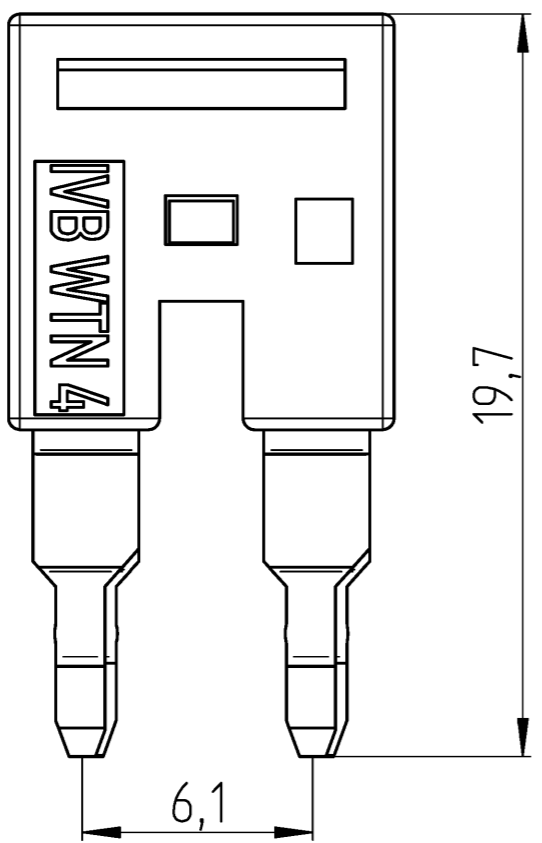

Weitere Daten siehe KATALOG oder eKatalog  
 additional data see CATALOG or eCATALOG  
[www.wieland-electric.com](http://www.wieland-electric.com)  
[eshop.wieland-electric.com](http://eshop.wieland-electric.com)

Tolerierung Size ISO 14405 © / Tolerance system Size ISO 14405 ©.  
 (This ISO-standard describes the envelope principle. According to the envelope principle the deviations of form and parallelism are limited by the size tolerances).  
 ja/yes  Stoffverbots- und Deklarationsliste nach WN 5020.010 ist einzuhalten.  
 Conformity with Wieland document WN 5020.010 e (list of prohibited / declarable hazardous substances) to be declared!

Freitoleranz nach General tolerance CAD - Zeichnung, keine manuellen Änderungen CAD - drawing, no manual modifications allowed 1. Verwendung: First Use: Blatt: 1 von 1 Sheet: 1 of 1

| Bestell-Nr.<br>/order no. | Polzahl P<br>/number of poles P | Typ<br>/type | Farbe<br>/colour |
|---------------------------|---------------------------------|--------------|------------------|
| 0D.S04.3227.5             | 2                               | IVB WTN 4-2  | rot / red        |
| 0D.S04.3327.5             | 3                               | IVB WTN 4-3  | rot / red        |
| 0D.S04.3427.5             | 4                               | IVB WTN 4-4  | rot / red        |
| 0D.S04.3527.5             | 5                               | IVB WTN 4-5  | rot / red        |
| 0D.S04.4027.5             | 10                              | IVB WTN 4-10 | rot / red        |

|                                     |  |  |             |                             |       |
|-------------------------------------|--|--|-------------|-----------------------------|-------|
| Werkstoff / Material                |  | Tag/Date                                     | Name        | Zeichnung Nr. / Drawing No. | Index |
| Maßstab / Scale                     |  | 08.10.2025                                   | Eichhorn N. |                             |       |
| Vol. mm³ / Of./Srf. mm²             |  | Elektronische Freigabe<br>Electronic Release |             | T 0D.S04.3227.5 13K         |       |
| Ersatz für / Replacement for:       |  | Maße in mm / Dimensions are in mm            |             |                             |       |
| Type                                |  | Benennung/Title                              |             |                             |       |
| Index Datum / Blatt<br>Date / Sheet |  | VERBINDUNGSSTECKER<br>connection plug        |             |                             |       |
| Änderung / Revision                 |  |  |             |                             |       |